

**Star** LLU 13-1 A

**8'000 min -1 / rpm**  
**i = 1:1**

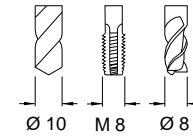

Radial-Bohr-Fräseinrichtung  
 Radial Drilling and Milling Unit  
 Unità radiale di foratura e fresatura  
 Unité de perçage et de fraisage radial

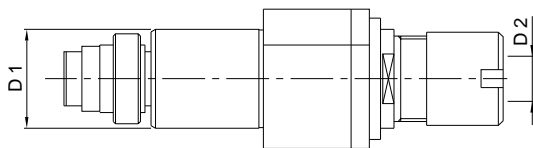
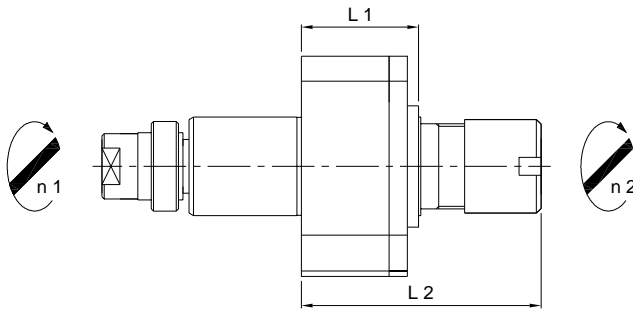

**Machine Types**  
 SR-25J SR-32J N  
 SR-32J

**Auch einsetzbar auf / Also usable on**  
 ECAS-12  
 ECAS-20  
 SR-20J C  
 SR-20J N  
 SR-20RII  
 SR-20RIII

| Ref. No.<br>Star | Ref. No.<br>Su-matic | Radialkopf<br>Radial Head | L 1                         | L 2  | B 1  | D 1 | D 2<br>Ø max. | D 3 | Nm<br>max. | Schmierung<br>Lubrication | rpm max.<br>min -1                 | i<br>n 1 : n 2 | Zubehör<br>Accessory | Page   |            |
|------------------|----------------------|---------------------------|-----------------------------|------|------|-----|---------------|-----|------------|---------------------------|------------------------------------|----------------|----------------------|--|------------|
| A                | 571-61               | 14101000050               | LLU 13-1 A<br>Hi-Q / ERM 16 | 26.1 | 53.4 | 31  | 22            | 10  | 49         | 13                        | Fettschmiering<br>Lubricant grease | 8'000          | 1:1                  | Spannzangen / Collets<br>Dichtscheiben / Sealing Disks | 012<br>012 |